

TM

AlfrescoTM

Open Air Culinary Systems



**AR REFRIGERATORS
CARE & USE MANUAL**

***PLEASE READ THIS MANUAL BEFORE USING YOUR APPLIANCE.
KEEP THIS MANUAL IN A SAFE PLACE FOR FUTURE REFERENCE.***

ASSEMBLER / INSTALLER

Leave these instructions with the customer.

CONSUMER/USER

Read these instructions and keep them in a safe place for future reference.

NOTE TO CUSTOMER:

This appliance was carefully packed and thoroughly inspected before leaving our factory. Responsibility for its safe delivery was assumed by the carrier upon acceptance of the shipment. As directed on the packing carton, claims for loss or damage sustained in transit must be made to the carrier as follows:

A) **EXTERIOR DAMAGE:** Make a thorough damage notation on your delivery receipt and have driver acknowledge by signature and date. Send a written request asking for an inspection report from the carrier. Include the name of the carrier representative and the date the inspection was requested. Retain the inspection report and receipt for filing of a claim.

B) **CONCEALED DAMAGE:** This must be reported to carrier within fifteen days of receipt. Obtain inspection report from the carrier. Retain inspection report for filing of a claim. **DO NOT RETURN DAMAGED MERCHANDISE TO MANUFACTURER OR DEALER - FILE CLAIM WITH THE CARRIER.**

SERIAL PLATE INFORMATION

SERIAL PLATE

⚠ WARNING

FOR OUTDOOR USE ONLY

NOT TO BE INSTALLED IN OR ON RECREATIONAL VEHICLES AND / OR BOATS.

⚠ AVERTISSEMENT

POUR UTILISATION À L'EXTÉRIEUR

NE PAS ÊTRE INSTALLÉ DANS OU SUR DES VÉHICULES RÉCRÉATIFS ET / OU DES BATEAUX.

⚠ WARNING

ELECTRICAL PARTS AND COMPONENTS:



DO NOT SPLASH OR SPRAY WATER FROM A HOSE ONTO THE REFRIGERATOR. DO NOT WET WHEN CLEANING. DOING SO MAY CAUSE AN ELECTRICAL SHOCK, INJURY OR DEATH.

⚠ AVERTISSEMENT

PIÈCES ET COMPOSANTS ÉLECTRIQUES :



NE PAS ÉCLABOUSER OU VAPORISER D'EAU SUR LE RÉFRIGÉRATEUR. NE PAS MOUILLER LORS DU NETTOYAGE. CELA PEUT PROVOQUER UN CHOC ÉLECTRIQUE, DES BLESSURES OU LA MORT.

⚠ WARNING

ELECTRICAL GROUNDING INSTRUCTIONS:

THIS OUTDOOR REFRIGERATOR APPLIANCE IS EQUIPPED WITH A THREE-PRONG (GROUNDING) PLUG FOR YOUR PROTECTION AGAINST SHOCK HAZARD AND SHOULD BE PLUGGED DIRECTLY INTO A PROPERLY GROUNDED THREE-PRONG RECEPTACLE. DO NOT CUT OR REMOVE THE GROUNDING PRONG FROM THIS PLUG.

⚠ AVERTISSEMENT

INSTRUCTIONS DE MISE À LA TERRE ÉLECTRIQUE

CET APPAREIL DE RÉFRIGÉRATION EXTÉRIEUR EST ÉQUIPÉ D'UNE FICHE À TROIS BROCHES (MISE À LA TERRE) POUR VOTRE PROTECTION CONTRE LES RISQUES D'ÉLECTROCUTION ET DEVRAIT ÊTRE BRANCHÉ DIRECTEMENT DANS UNE PRISE À TROIS BROCHES CORRECTEMENT MISE À LA TERRE. NE PAS COUPER OU ENLEVER LA PRISE MISE À LA TERRE.

DANGER



R290

RISK OF FIRE OR EXPLOSION DUE TO PUNCTURE OF REFRIGERANT TUBING. FLAMMABLE GAS USED AS REFRIGERANT. DO NOT USE MECHANICAL DEVICES TO DEFROST REFRIGERATOR. DO NOT PUNCTURE REFRIGERANT TUBING. CONSULT REPAIR MANUAL / USER GUIDE BEFORE ATTEMPTING TO SERVICE THIS PRODUCT.

DANGER



R290

RISQUE D'INCENDIE OU D'EXPLOSION DÙ À LA PERFORATION DES TUBES DE RÉFRIGÉRANT. GAZ INFLAMMABLE UTILISÉ COMME RÉFRIGÉRANT. NE PAS UTILISER D'APPAREILS MÉCANIQUES POUR DÉCONGELER LE RÉFRIGÉRATEUR. NE PAS PERCER LES TUBES DE RÉFRIGÉRANT. CONSULTER LE MANUEL DE RÉPARATION/ GUIDE D'UTILISATION AVANT TOUTE INTERVENTION SUR CE PRODUIT.

CAUTION



R290

RISK OF FIRE OR EXPLOSION.

DISPOSE OF PROPERLY IN ACCORDANCE WITH FEDERAL AND LOCAL REGULATIONS.

FLAMMABLE REFRIGERANT USED.

MISE EN GARDE



R290

RISQUE D'INCENDIE OU D'EXPLOSION.

ÉLIMINER CONFORMÉMENT AUX RÉGLEMENTATIONS FÉDÉRALES ET LOCALES.

RÉFRIGÉRANT INFLAMMABLE UTILISÉ.

REFRIGERATOR COMPONENTS:

Your refrigerator is configured from the factory with a door or two drawers. Both units operate in the same manner for refrigeration and share the same control unit except for its different functionality.

DOOR MODEL:

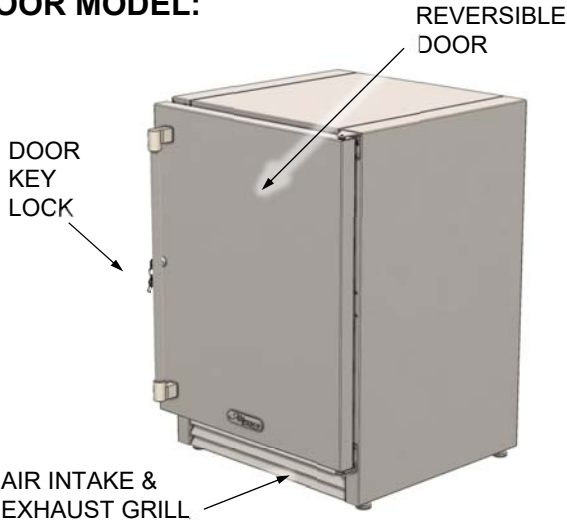

DRAWER MODEL:

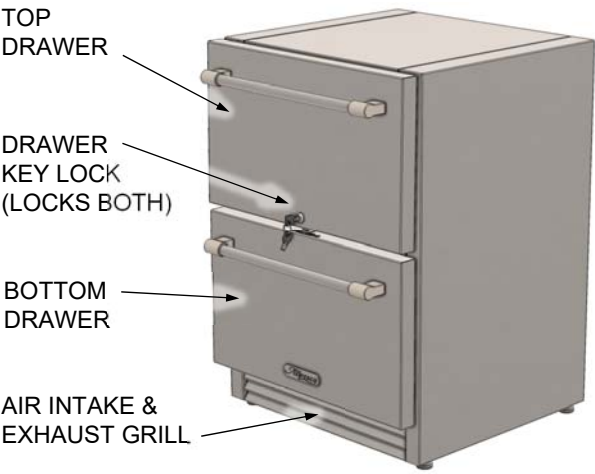

UNIT BACK SIDE: (SAME FOR BOTH MODELS)

Please refer to section “SELECTING LOCATION” on page 11 for proper front and rear ventilation requirements.

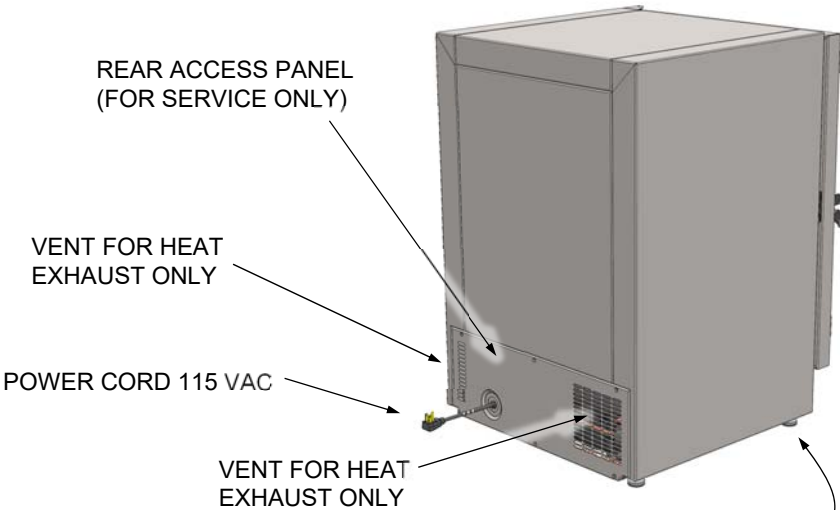

INTERIOR COMPONENTS:

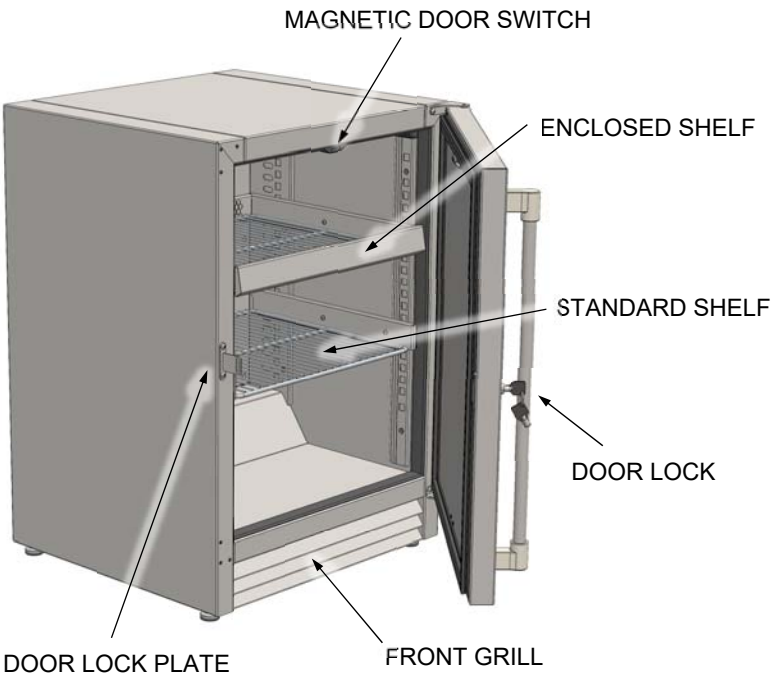

ADJUSTABLE LEGS ROTATE
CLOCKWISE = LOWER
COUNTER CLOCKWISE = HIGHER

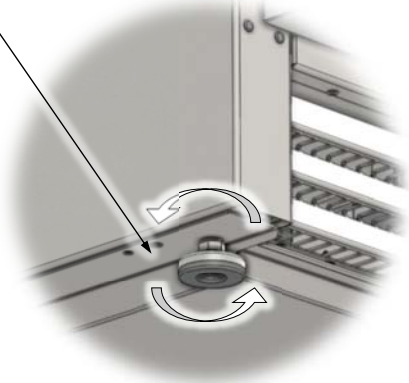

INTERIOR COMPONENTS (Cont.)

DOOR MODEL:

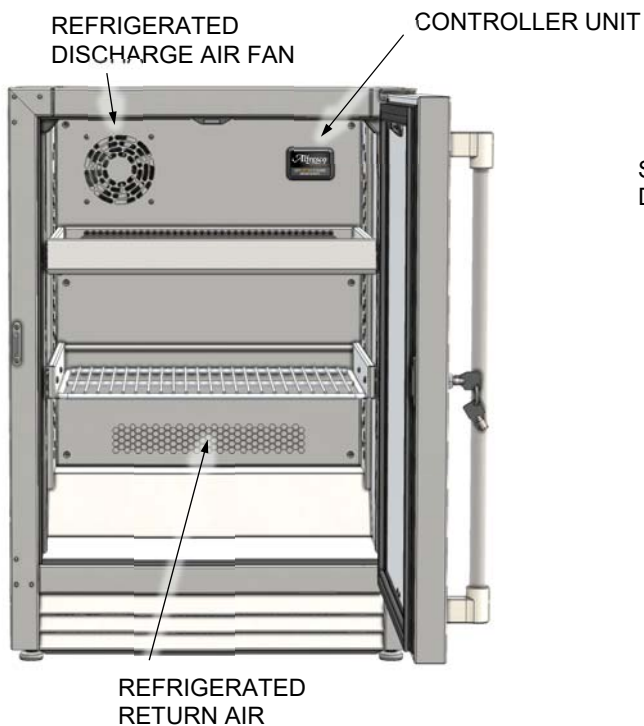

DRAWER MODEL:

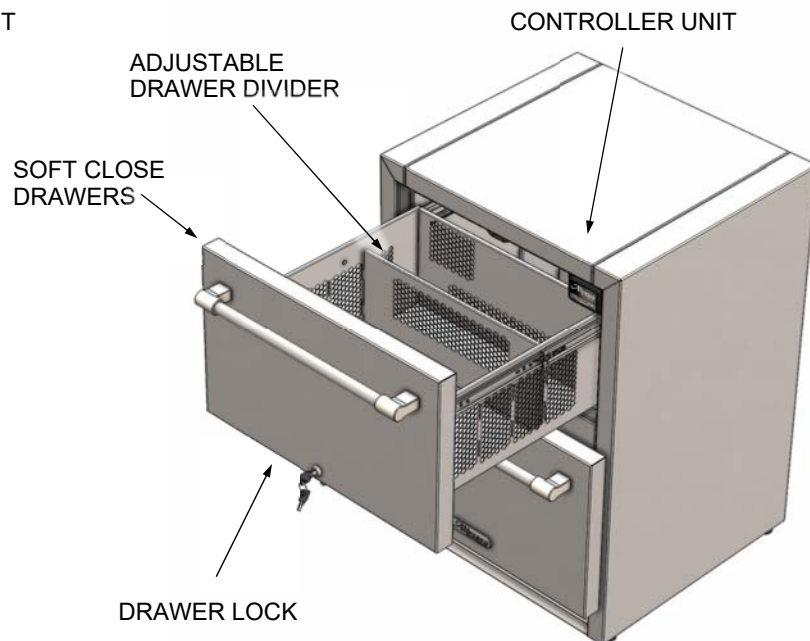

BOTTOM GRILL / USB ACCESS PORT:

At the bottom of the refrigerator, both door or drawer models, there is a intake and exhaust vent grill that allows user access for:

- Cleaning the front intake and exhaust grill.
- Cleaning the outside temperature sensor.
- Cleaning the refrigeration condenser coil.
- Accessing the USB port for:
 - Software (firmware) updates.
 - Exporting data recorded for trouble-shooting and performance monitoring.

NOTE:

Keep the USB Port cover closed and **latched** at all times for continued weather protection.

Leaving the USB Port open to debris and humidity could lead to port deterioration and it is not covered under warranty.

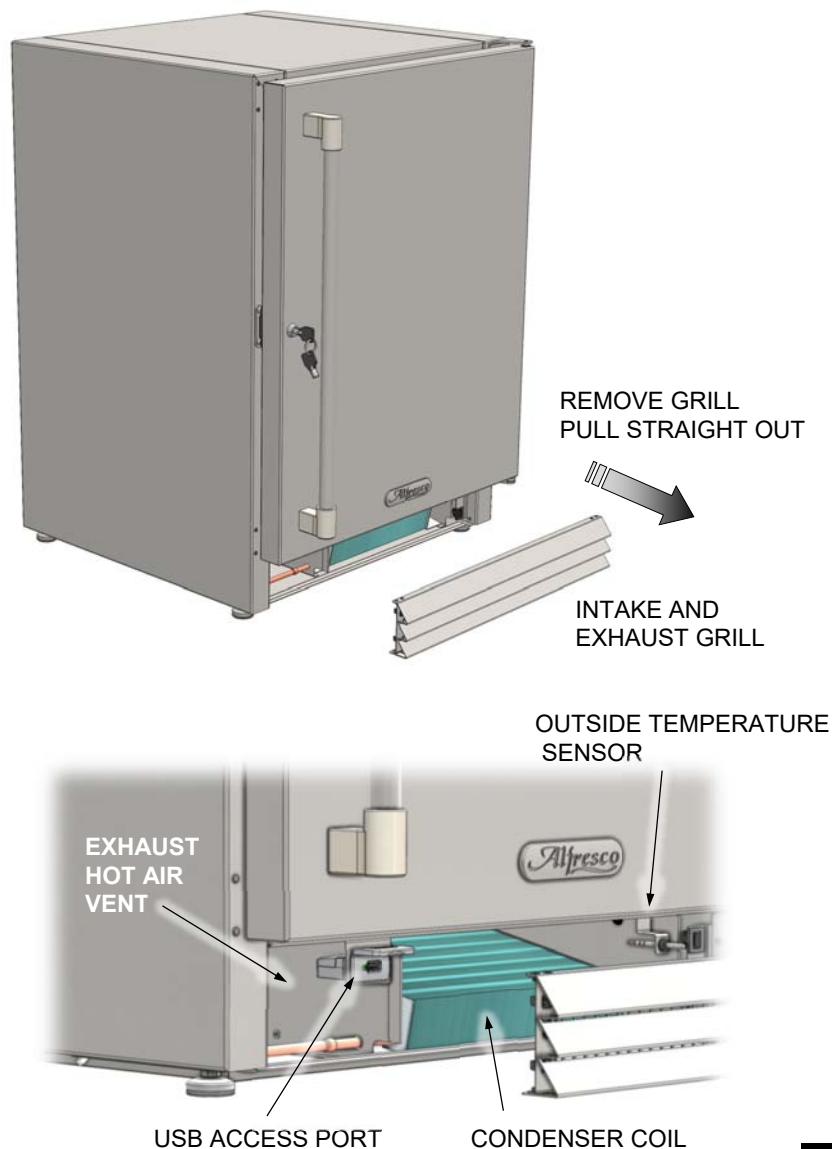

CONTROLLER QUICK GUIDE

Your Alfresco AR-24 refrigerator comes preconfigured from the factory for operation upon plugging the unit to an 115 VAC outlet (GFCI preferred).

The controller display is located on the interior back wall of the refrigerator just above the top shelf on **door models** and on the front upper corner on **drawer models** only.

The controller display is touch sensitive and it is used to:

- Turn Refrigeration **ON** and **OFF**
- Adjust Temperatures.
- Time and Date.
- Light Brightness and Color

The controller has a rechargeable backup battery for information pertaining to your preferred settings as the ones described above.

If the refrigerator is unplugged from the power line, it will of course stop working.

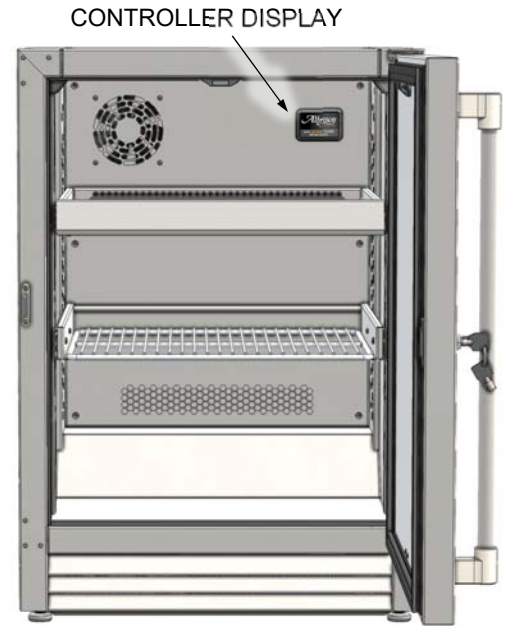

DOOR MODEL SHOWN

If the refrigeration was turned **ON**, when unplugged (or during a power loss), the refrigerator will re-start with the previous settings it was working with, when the refrigerator is plugged back in or power is restored.

If the refrigerator was powered but refrigeration was turned **OFF**, the refrigerator will return to this same mode if power is lost and restored.

Please note that if the unit is unplugged for more than 48 hrs., the date and time settings will be reset, but all other settings such as refrigeration ON / OFF, temperature, light color and brightness will remain the same upon power being restored.

CONTROLS

Upon powering the system up by plugging the unit, the display will start initializing with a black screen and immediately go to the BOOT screen.



BOOT SCREEN

The controller is starting up and a circle with small dots flashes as the system initializes. This process takes about 10 ~ 20 seconds.

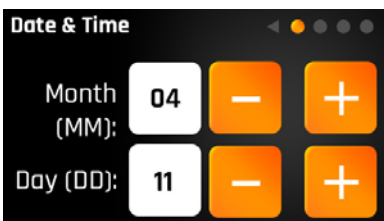

DATE & TIME SCREEN

Enter the Month (MM) and Day (DD).

This information is required as the refrigerator controller records all working parameters and conditions of the refrigeration system with a proper timestamp.

TIP: Note on the display that the upper right corner of the screen indicates the number of screens that are available to scroll through by swiping left or right. Each available screen is indicated by a grey dot and the orange dot represents the screen in view.

When an arrow is displayed on the corner next to the series of dots, it will indicate the direction that it is required to swipe in order to exit the selection screens.

After the initial date and time setup is completed, if the user selects any menu item but does not complete the task, the screen will revert back to the previous screen.

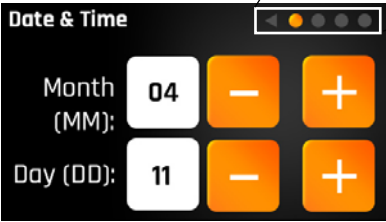

user swipes or selects menu will revert back

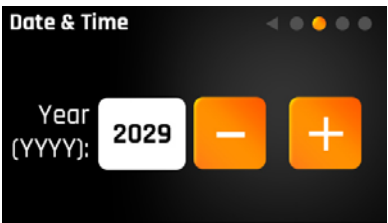

YEAR
Select the year.

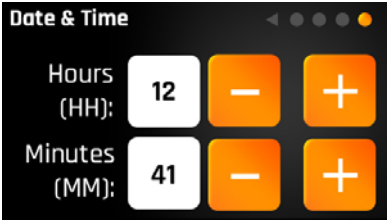

TIME & MINUTES
Select the current time by number (12 Hr).

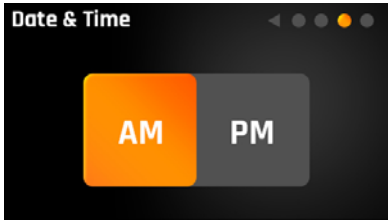

AM / PM
Select AM / PM by toggling between then highlighted item is orange.
► You can now swipe left to exit this initial setup.



The refrigerator controller will now start the unit, lights will come on and the refrigerator will start cooling the unit.
Initially and after every power on/off cycle (loss of power or setting the refrigeration system OFF) will delay the start up sequence of the compressor for 2 minutes. The compressor will start after this delay period.

DISPLAY SYMBOLS AND MEANING

Once the refrigeration system is running, the display will show the following icons:

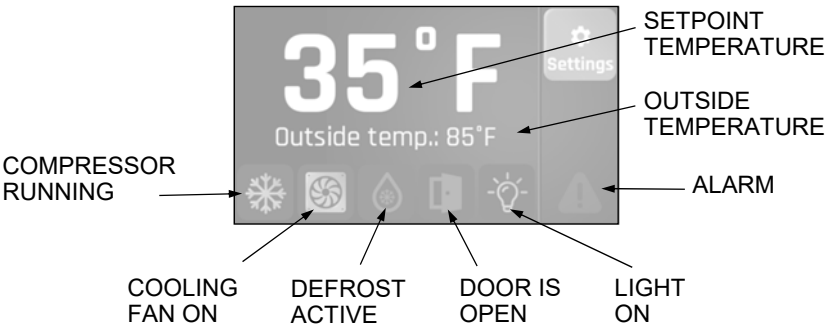

CHANGING SETTINGS: (SETTINGS MENU # 1)

From the main running screen previously shown , you can now access all settings by pressing the settings button on the upper right corner:

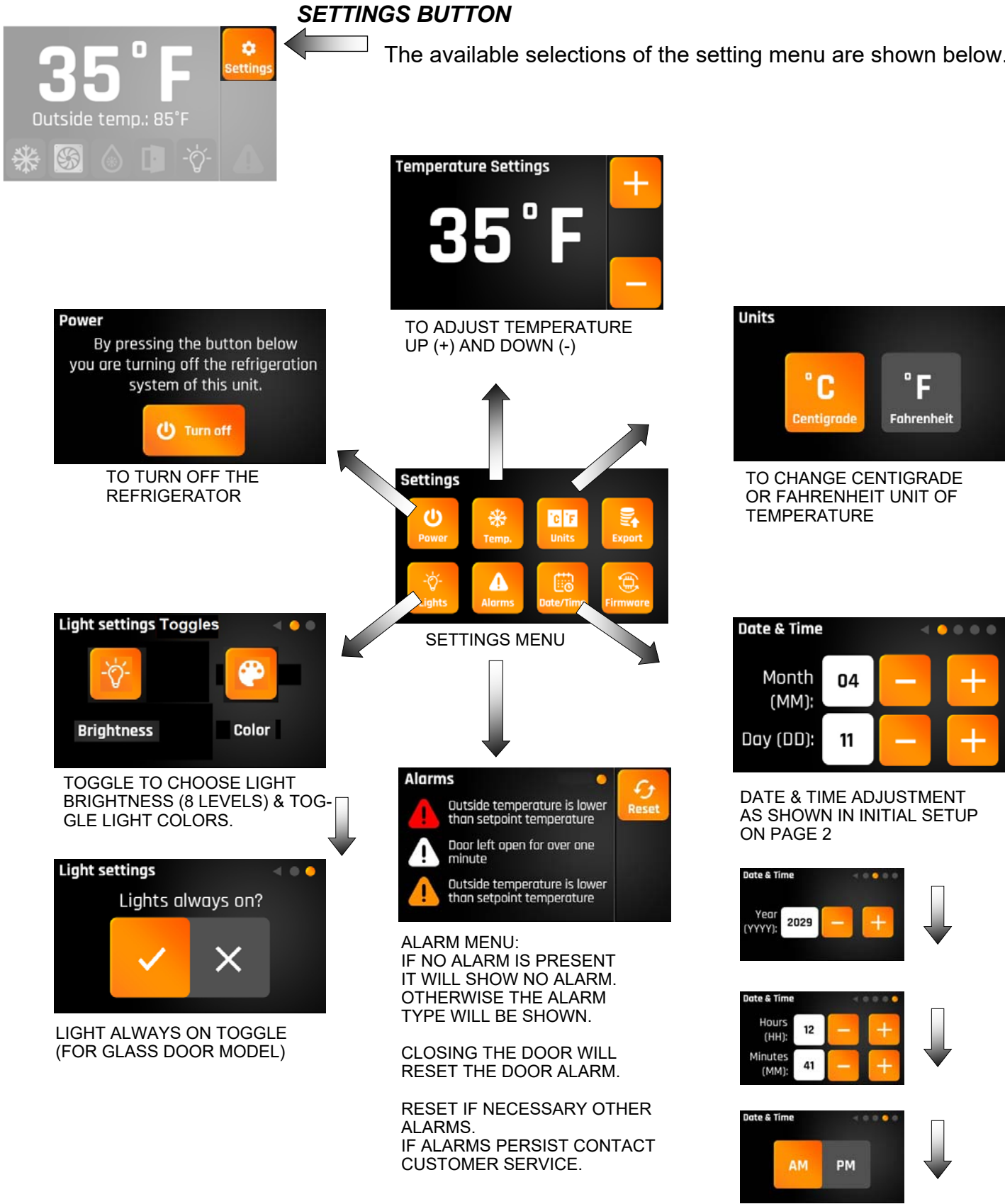

NOTE:

When the refrigerator is manually turned OFF, the unit will revert to the START Screen shown below.

To restart the refrigerator cooling, swipe left or right. The refrigerator will now start with the last temperature setting that was running previously setup with.

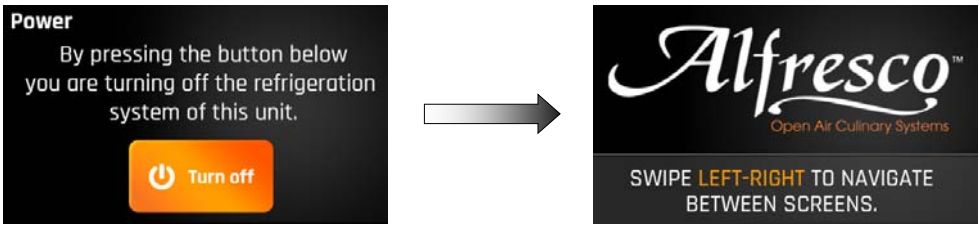

CHANGING SETTINGS: (CONT.)

Export and Firmware updates are meant for troubleshooting the refrigerator and allows to download running conditions information and data as well as to update the controller software if required.

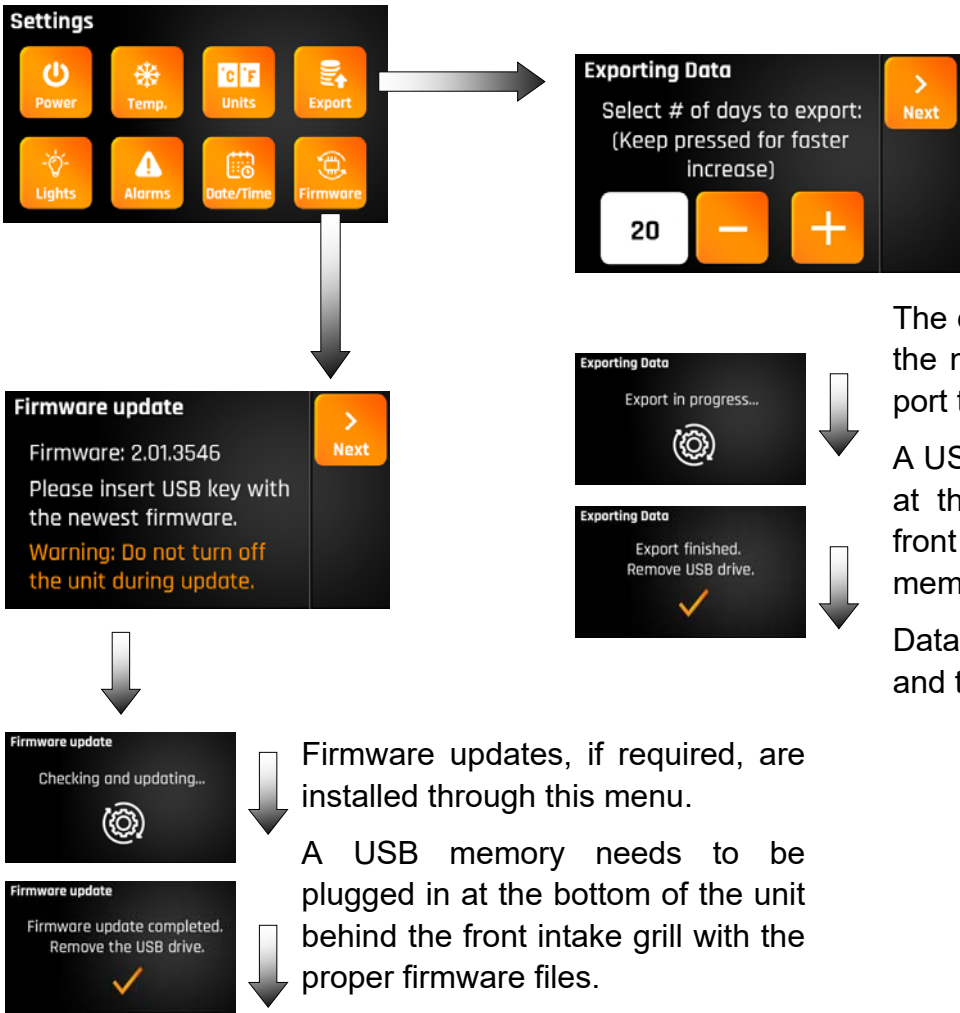

The exporting of data requires to select the number of days is required for export to a USB memory.

A USB memory needs to be plugged in at the bottom of the unit behind the front intake grill. All data in the USB memory will be erased before export.

Data exported is solely for factory use and troubleshooting

Firmware updates, if required, are installed through this menu.

A USB memory needs to be plugged in at the bottom of the unit behind the front intake grill with the proper firmware files.

This is only to be used for service.

CARE AND MAINTENANCE OF YOUR REFRIGERATOR:

Stainless Steel is widely used for kitchen equipment because of its strength, its ability to resist corrosion and its ease of cleaning. In fact, stainless steel ranks alongside glass and new china in terms of "ease of cleaning" and in percentage removal of bacteria during washing. As a result of these virtues, the metal is often taken for granted and it is assumed that no problems will arise during its usage. However, some care is required to ensure that the stainless steel can live up to this reputation.

DAY TO DAY CARE

To maintain the original appearance of your *Alfresco* Refrigerator, a regular cleaning routine should be carried out using the following guidelines:

After use, wipe the unit with a soft, damp, soapy cloth and rinse with clean water, preferably warm/hot water. This should remove most substances encountered during use.

For more tenacious deposits, including oil, grease and water-borne deposits, use a multipurpose cream cleanser applied with a soft damp cloth. Rinse with clean water.

Harsh abrasives and scouring materials should not be used for cleaning stainless steel as they will leave scratch marks in the surface and damage the appearance. Likewise do not use wire brushes, scrapers or contaminated scouring pads.

If the preceding guidelines are adhered to, your *Alfresco* Stainless Steel Refrigerator should offer excellent life and live up to its reputation of being "stainless".

Neglect of this practice, however, can lead to deterioration of the surface and, in some extreme cases, corrosion of the steel itself. The two most common types of corrosion that may be encountered, particularly on stainless steel, are rust marks and pitting of the surface.

RUST BROWN MARKS

When this type of staining occurs it is unlikely that rusting of the stainless steel itself caused the marks. Similar marks can be found with both porcelain and plastic sinks. The rust marks are more likely the result of small particles of "ordinary-steel" which have become attached to the surface and subsequently rusted in the damp environment. The most common source of such particles is from "wire wool" scouring pads, but may also occur from carbon steel utensils and old cast iron water supply pipes.

These brown marks are only superficial stains, which will not harm the unit; they should be removable using a soft damp cloth and multi-purpose cream cleanser. Occasionally, it may be necessary to resort to a proprietary stainless steel cleanser, to return the surface of the unit to its original condition.

PITTING

Another form of corrosion, which occasionally occurs in stainless steel, is pitting of the surface. The reason for this corrosive attack can usually be attributed to certain household products, for example:

BLEACHES

Most common domestic bleaches & sterilizing solutions contain chlorine in the form of sodium hypochlorite. If used in concentrated form, bleaches can attack the stainless steel, causing pitting of the surface. They should always be used to the strengths prescribed by the manufacturer and should be thoroughly rinsed off with clean water immediately after use.

FOODSTUFFS

In general, stainless steel is fully resistant to all foodstuffs in common use. Only in isolated cases, such as when concentrated salt and vinegar mixtures are allowed to remain in contact with the steel for a long period, can any surface marking result.

TROUBLESHOOTING:

BEFORE CALLING FOR SERVICE

If the unit does not function properly use the following checklist before contacting your dealer for service. You may save the cost of a service call and the inconvenience of being without your refrigerator.

REFRIGERATOR NOT COOLING ENOUGH

Lower the temperature of the cabinet by adjusting the digital thermostat to a lower setting.

NOISY OPERATION

This is usually caused by the unit not being level. Reposition the refrigerator to see if the noise can be eliminated. (See unit leveling)

MOISTURE ON OR IN UNIT

Warm moist air will condense on cold surfaces. Condensation inside the unit can be caused by too frequent or prolonged opening of the doors. Moisture can also be caused by the thermostat being set too cold. Check the temperature of the unit. Try adjusting to a slightly higher temperature to see if the problem can be eliminated. Minimize door openings and verify that the door gasket is sealing properly around the door or drawer perimeter.

APPLIANCE RUNS TOO LONG

Running time will change with outside temperature, number of times and length-of-time the doors are open, etc. This is normal in hot or humid weather and is not detrimental to the operation of the unit

LOCATING AND INSTALLING YOUR REFRIGERATOR:

SELECT LOCATION

The proper location will ensure peak performance of your refrigerator. Choose a location where the unit will be out of direct sunlight and away from heat sources. Your *Alfresco* refrigerator is designed to be operated in a properly ventilated area with an ambient temperature of not less than 30°F, nor more than 120°F.

Your *Alfresco* refrigerator requires ventilation from the bottom front of the unit. Keep the area directly in front and behind the unit clear of obstructions. For a built-in unit, make sure the back and bottom of the unit have at least 2 inches of clearance to the cabinet, and that the unit can be easily removed from the cabinet for servicing.

ELECTRICAL SERVICE

All ETL listed refrigerators are equipped with a three pronged plug. Use only the electrical cord supplied with the unit, which must be plugged directly into a properly grounded 3-pronged outlet, preferably a GFCI circuit, in accordance with the National Electrical Code and applicable local codes and ordinances. The third prong (grounding prong) **SHOULD NOT**, under any circumstances, be cut or removed. Do not use an extension cord with this unit.

ACCESSORIES:



STANDARD GRATE:

- R-24-SG(24" UNIT)
- R-28-SG(28" UNIT)

WINE GRATE:

- R-24-WG (24" UNIT)
- R-28-WG (28" UNIT)

ENCLOSED SHELF PERIMETER + SLIDES:

- R-24-ES (24" UNIT)
- R-28-ES (28" UNIT)



OPEN SHELF WITH STANDARD GRATE + SLIDES:

- R-24-OS(24" UNIT)
- R-28-OS(28" UNIT)



ACCESSORIE DRAWER + SLIDES:

- R-24-AD(24" UNIT)
- R-28-AD(28" UNIT)

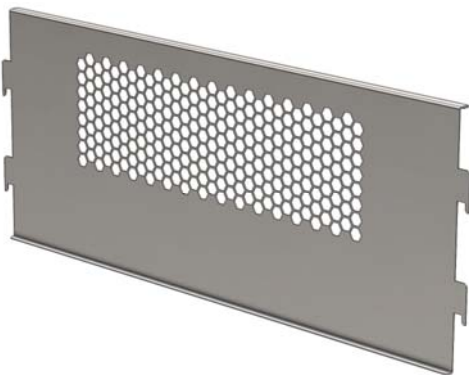

DRAWER DIVIDER: (DRAWER MODELS ONLY)

- R-24D-DD (24" UNIT)
- R-28D-DD (28" UNIT)

SHELF AND DRAWER ADJUSTMENTS

When adjusting the location of your shelves or drawer to your preference, please adjust them according to the following procedure. These instructions apply to enclosed or open shelves and drawers of any size with self closing mechanisms.

ENCLOSED SHELF



OPEN SHELF



DRAWER



SHELF OR DRAWER SLIDES SEPARATION:

- Separate the shelf or drawer tracks from the shelf or drawer by first extending the slides to their maximum extended position.
- On each side of the slides there is a red lever that allows the drawer slide to be separated.
- Push the RIGHT red lever DOWN and the LEFT lever UP.
- Separate the Refrigerator BODY TRACKS from the shelf or drawer SLIDES themselves by sliding them apart.

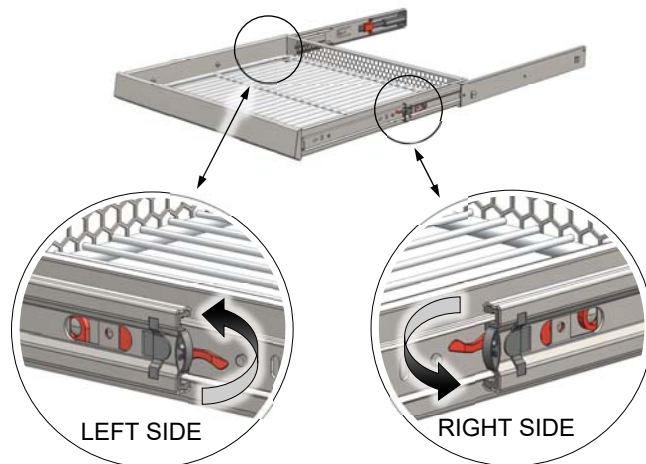

BODY TRACK INSTALLATION:

- Remove (or relocate) the body side TRACK by lifting the front of the body track, tilt left or right and pull forward the track.
- This will detach the body track section from the body of the refrigerator.
- Relocate (or install) into a new set of slots to suit your particular requirements of shelf height.
- Insert the REAR TAB of the body track assembly into the rear track standard at a slight angle (left or right).
- Align the FRONT TAB of the body track assembly into the front track standard and push down into the corresponding opening making sure the track assembly is straight and leveled.
- Repeat this operation for the opposite side track assembly.
- Extend the MID-SECTION of the drawer track assembly.

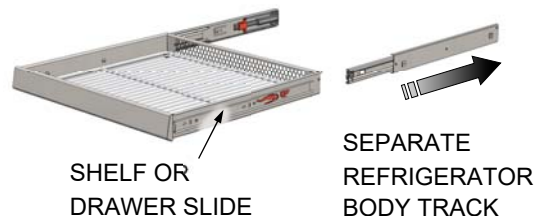

FRONT TRACK STANDARD

REAR TRACK STANDARD

MID-SECTION OF TRACK

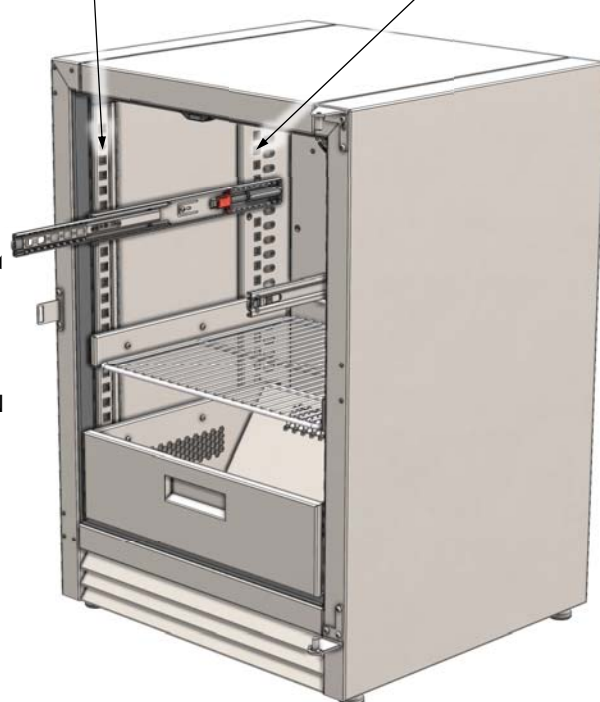

BODY TRACK ASSEMBLY

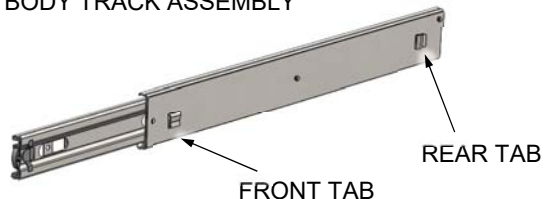

DOOR REMOVED FOR VIEWING PURPOSE ONLY.

SHELF OR DRAWER INSTALLATION:

- Install the shelf or drawer into the tracks you installed in the previous step.
- The shelf or drawer slides will fit in the track of the body by aligning the back edges of the slides into the black plastic track guides of the mid-section of the body track.
- **PUSH** the shelf or drawer fully into the refrigerator.
- You will hear a “click” when the red levers on the sides of the slide have locked into the mid section of the tracks.

*The shelf or drawer **might not** slide in smoothly as needed at this point. This is normal.*

This is due to the slight differences and leveling between the left and right slides with the tracks. They are normally out of alignment between both sides at this point.

To align the shelf slides and track as one single assembly please complete the required next steps:

SLIDE AND TRACK ALIGNMENT:

- **PULL** the shelf or drawer out to its fully extended position.
- Using a standard Phillips # 2 (mid size) screw-driver, loosen **ONE FULL TURN** the 4 screws from the shelf or drawer (there are 2 on each side).
- Make sure the screws are loose enough so the shelf or drawer can move up and down freely.
- Push the shelf or drawer completely inwards until the self closing mechanism is fully engaged.
- **PUSH** the entire shelf or drawer **DOWN** at the center. This will self align the left and right slides to both tracks on the body so they glide smoothly.
- **PULL** the shelf or drawer **OUT** a little at a time and fasten the first 2 front screws (left and right) of the slide...
- Continue pulling the shelf or drawer and fasten the rear slide screws.
- Now, your shelf or drawer should be operating **IN** and **OUT** correctly and smoothly .
- Repeat these last procedures if necessary.

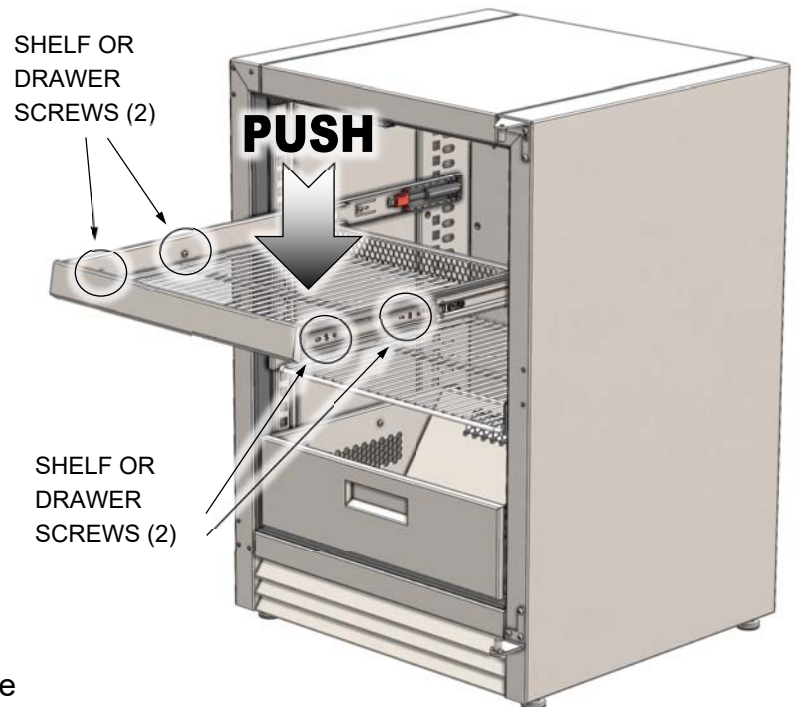
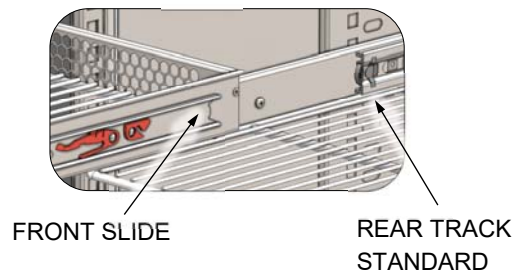
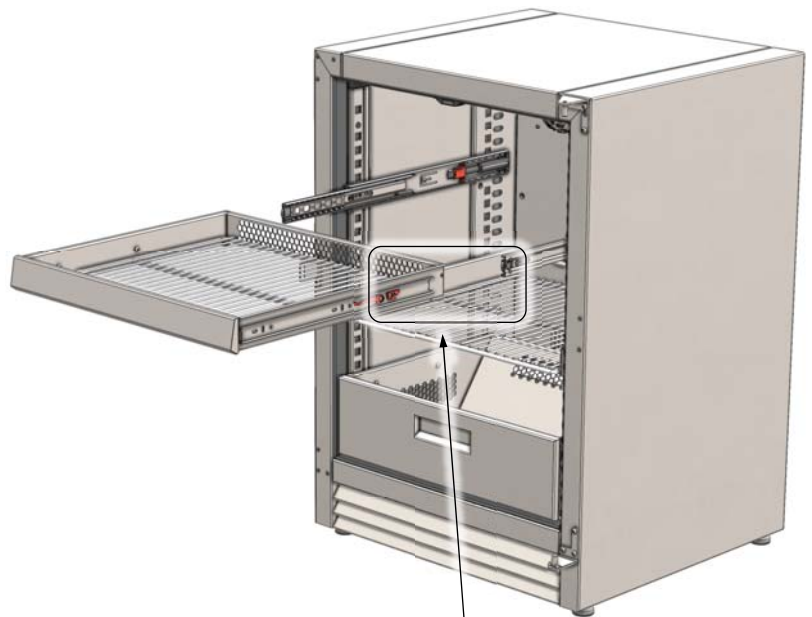

DOOR INSTALLATION KIT:

Your AR Refrigerator door comes with the door mounted on the right side of the refrigerator by default.

The door is reversible if required. (See door reversal instructions following this section).

Your AR refrigerator comes with the enclosed door kit which includes the necessary items to reverse your door.

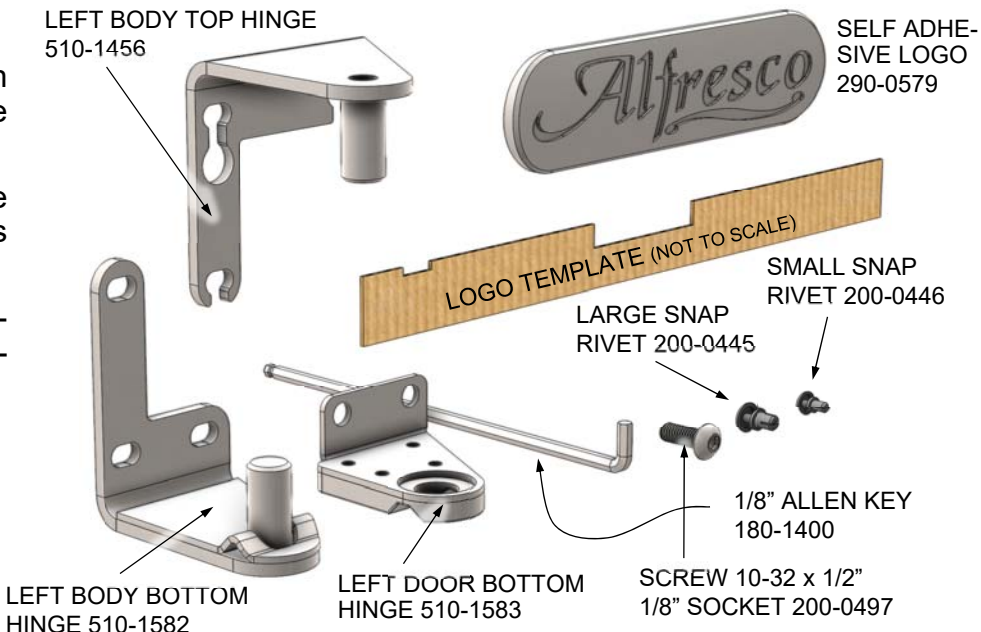

DOOR LOGO INSTALLATION:

Because the door can be reversed, the Alfresco Logo is not mounted on the door until you decide to which side the door should open.

To mount the Alfresco logo, you will use the enclosed cardboard logo template so it is consistent across all products (door or drawer versions)

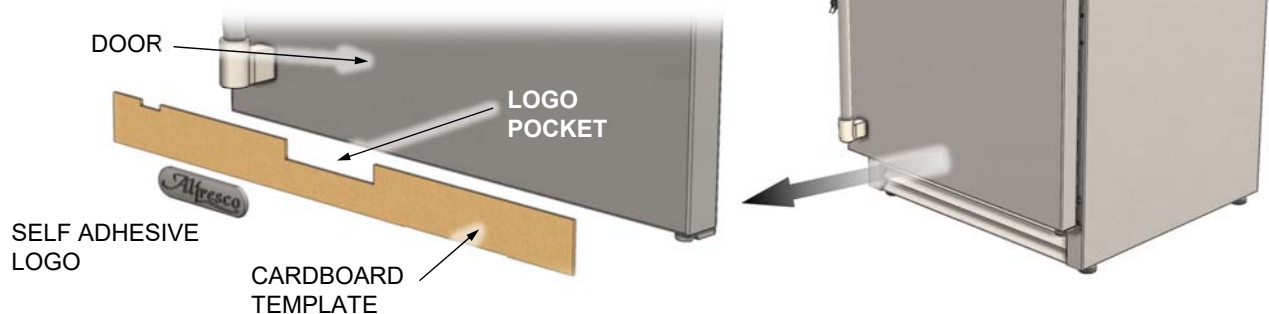

STEPS:

- *CLEAN* the door from all dirt and or factory protective oils that might be present on the surface of the stainless door, otherwise the self adhesive logo will fail to adhere to the stainless surface.
- USE a non-ammonia window cleaner to remove all oils from the surface. It is recommended to use standard household rubbing (isopropyl) alcohol to completely remove all oils in the area where the logo is to be mounted.
- Using Scotch® or masking tape, secure the cardboard template at the bottom of the door edge and centered side to side. Place tape at each end and at the bottom of the template to secure to the door.
- Peel the baking tape from the Alfresco logo and attach to the door while centering the logo inside the logo pocket of the template by aligning the bottom of the logo to the template cardboard pocket edge.
- Press firmly for a few seconds and the logo will be permanently attached to the door.
- Discard & recycle the cardboard template after use.

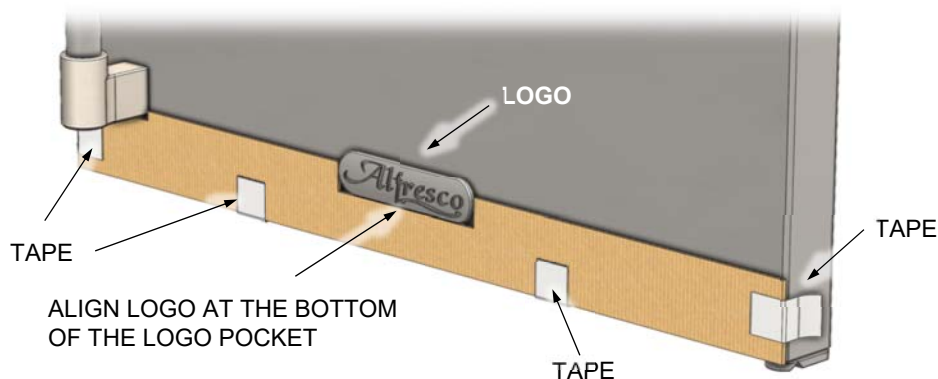

DOOR REVERSAL PROCEDURE

- Unplug your refrigerator or set the unit to OFF according to the instructions on page 8.



- OPEN the door of your refrigerator and using the enclosed 1/8" Allen Hex Key loosen the socket screws of the top hinge of the door assembly approximately 2 turns counter-clockwise.
- LIFT the top hinge while you HOLD and SUPPORT the door's weight on the bottom hinge of the door.
- Finish removing the top hinge by slightly moving or tilting forward (towards you) until you take the hinge OFF from the screws, the hinge screw **keyhole** slot and the door pivot pin. Set aside.
- LIFT the door from the bottom hinge and set aside.
- Remove the following components from the body of the refrigerator to prepare the unit for the left side door operation.

1/8" ALLEN
HEX KEY

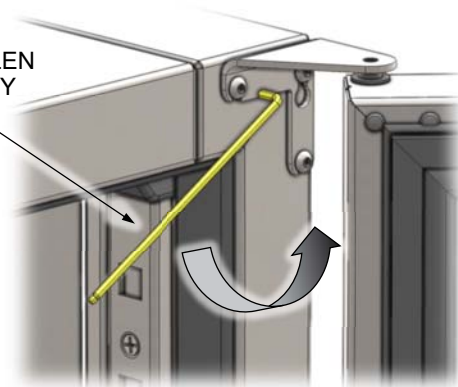

SCREW
KEYHOLE
SLOT

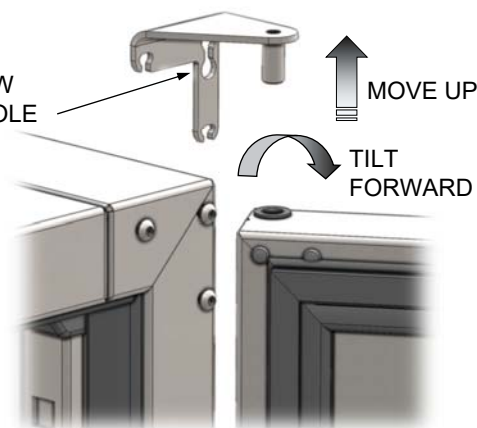

- Plastic rivets cover the existing holes when not in use. Simply use a small size flat screw driver to open the rivet head from the side. A stem will protrude out and the body of the rivet should come out of the threaded hole. Should the head become fully detached, simply pry the body in the same way, with a flat screw driver.
- Save all plastic rivets for use later.

PLASTIC
RIVETS

LOCK LATCH
ASSEMBLY
(FOR UNITS
WITH LOCK
OPTIONS)

SCREWS LEFT
FROM PREVIOUS
STEP

PLASTIC
RIVETS

PLASTIC
RIVETS

BOTTOM HINGE
ASSEMBLY

RIVET
HEAD

RIVET
BODY

PLASTIC RIVETS

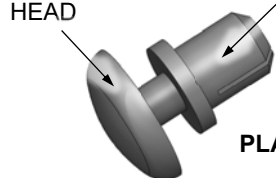

- Remove the lock latch if your unit is equipped with a locking door system. Use the 1/8" Allen Key provided.

Set aside.

- Remove the existing right bottom body hinge.
 - Use the 1/8" Allen Hex Key provided.
 - Remove the shim located between the refrigerator body and the hinge assembly.
 - The shim, if present is installed at the factory to perfectly align the hinge to the door.
 - The shim is reversible and should be set aside to install on the left side of the refrigerator in the following steps.

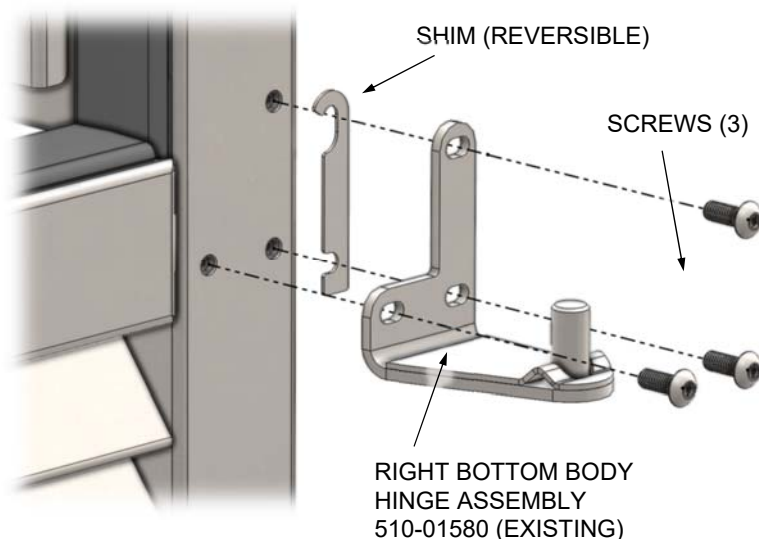
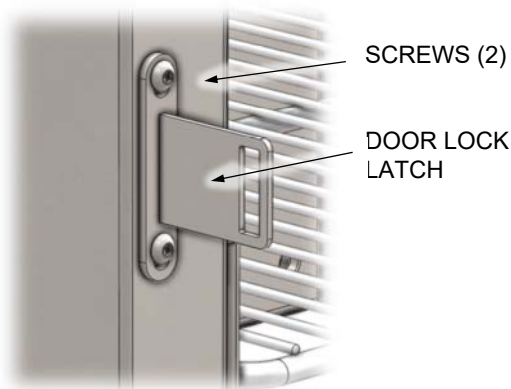

- Finish the transfer of all components for the left to the right of the refrigerator such as plastic rivets and door lock latch.
- Install plastic rivets in the screw holes left open after screw removal by simply inserting the rivet body in the threaded screw hole, and pushing the rivet head to lock and seal the opening.

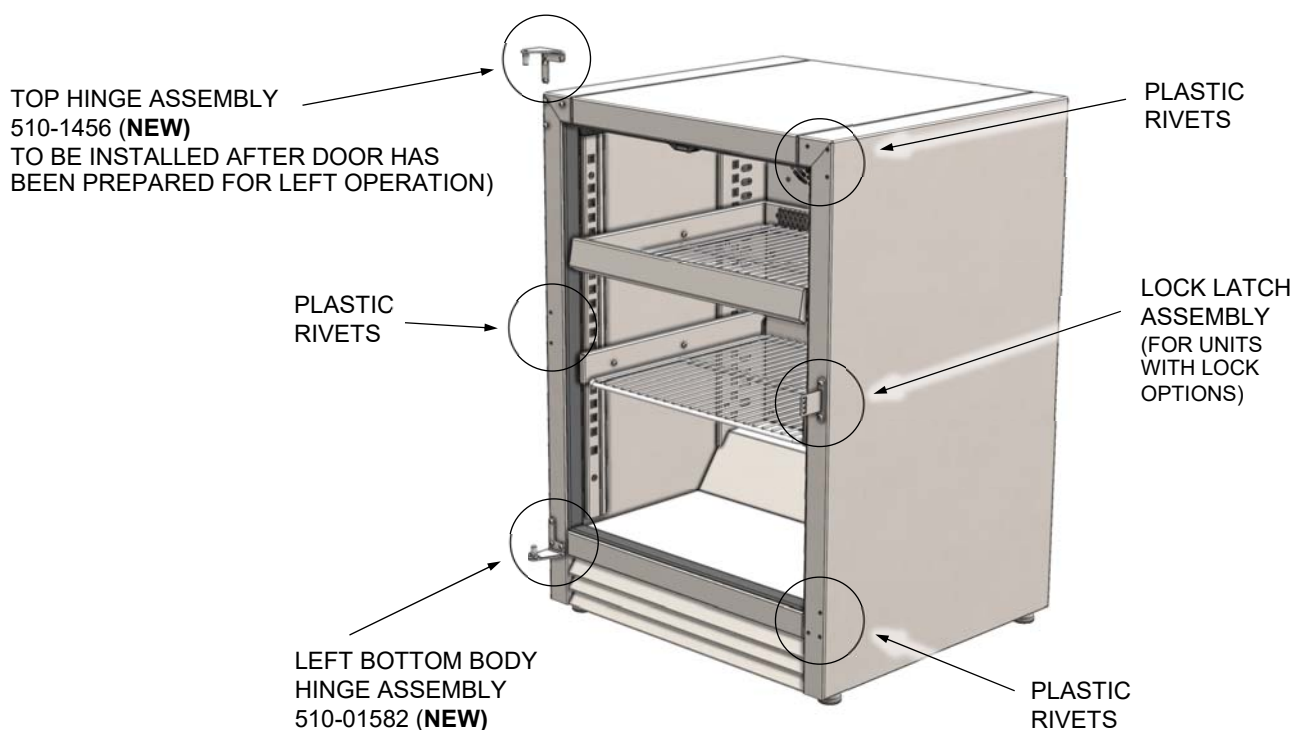

- Prepare the door for reversal by removing the following items:

- Plastic rivets
- Magnet for magnetic switch.
- Right bottom door hinge assembly

- The magnet housing is fastened with (2) screws 8-32 x 3/8".

- Remove plastic rivets with a small flat screw driver. Set aside.

- Remove right bottom door hinge assembly with the 1/8" Allen Key provided.

- DO NOT remove the plastic pivot bushing as it will now serve as the top bushing once the door is reversed.

- Reassemble the door for left door use by:

- Reversing the location of the magnet from top to bottom
- Reversing the plastic rivets for the magnet screw holes not in use.
- Reversing the plastic rivets near the top hinge area.
- Installing bottom door hinge assembly provided with the door kit. (510-1583) Fasten the 1/8" socket head screw tightly.

DEFAULT RIGHT SIDE DOOR

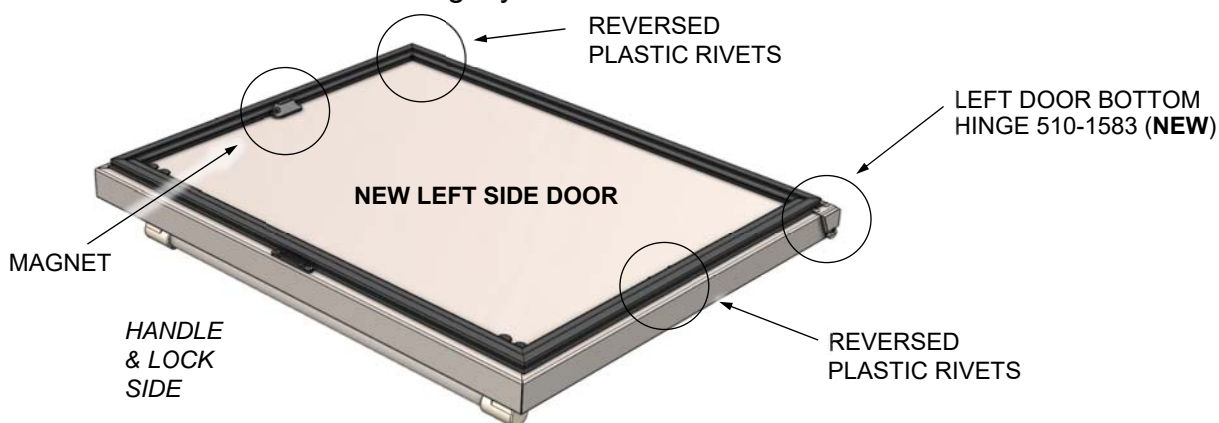
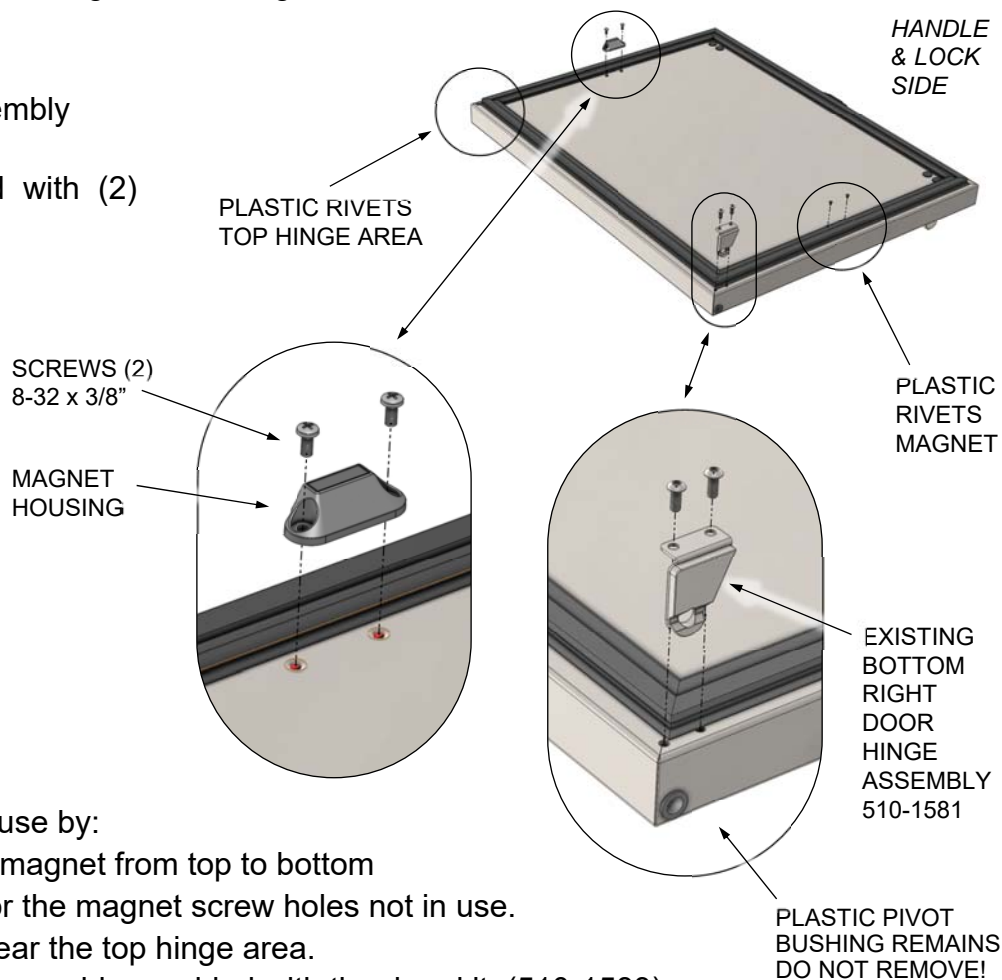

- Install the screws for the TOP LEFT BODY HINGE (510-1459 on page 13) that were removed on the steps of page 15 and reverse then to the left side.

DO NOT tighten these screws. Leave at least 1/8" gap between the screw head and body.

- Install the now reconfigured door on the refrigerator body BOTTOM hinge. Hold it in place.
- Install the TOP LEFT BODY HINGE by placing it the door pivot pin and through the screw keyhole. Reverse order as the door was removed on page 14. Lock in place.
- **TIGHTEN** all screws from the bottom body hinge and top body hinge while aligning the door to the body. Hinges allow approximately 3/32" movement side-to-side to align the door to the body properly.

DOOR REVERSAL IS COMPLETED. RESTORE POWER TO THE UNIT.

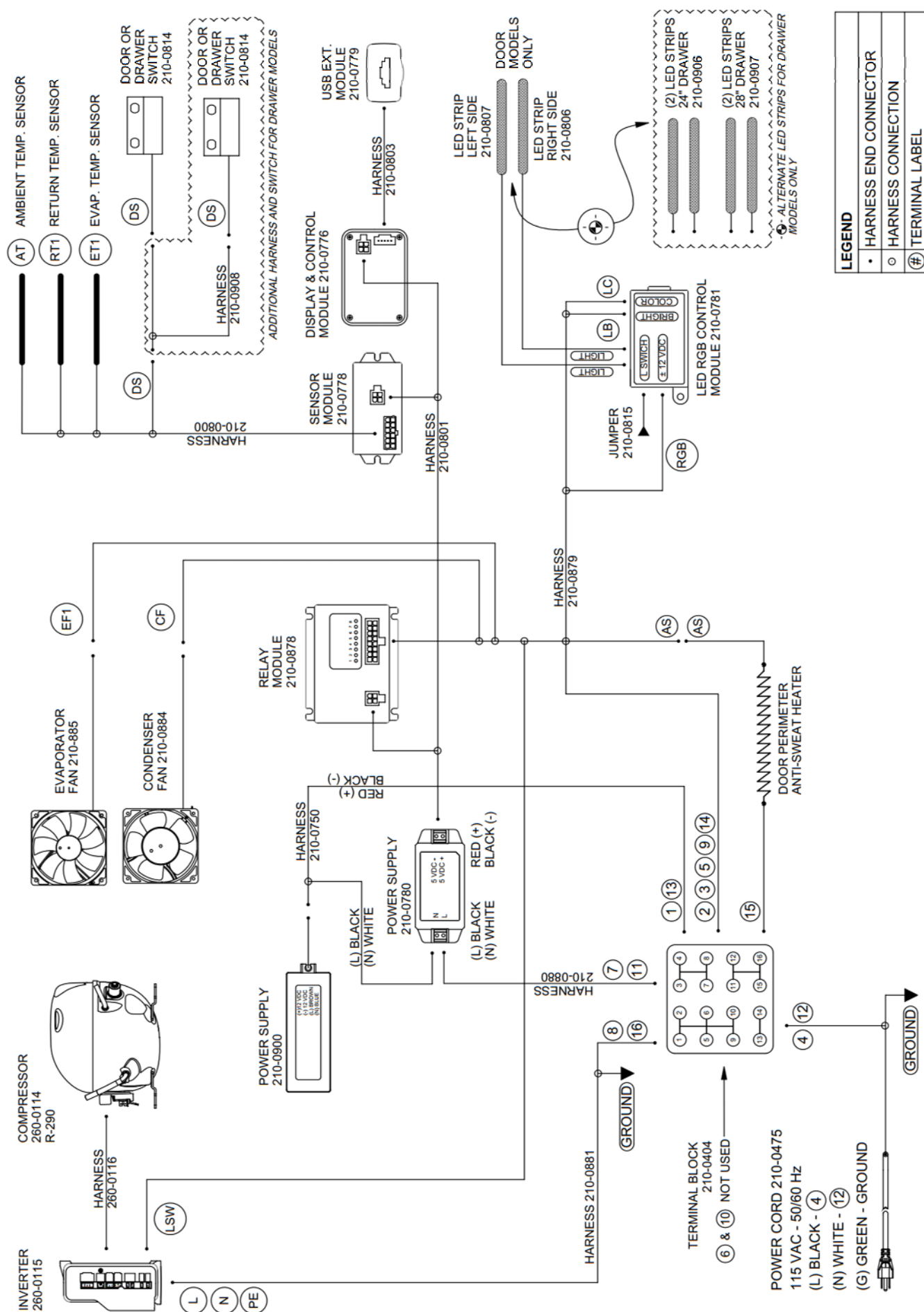

LEGEND	
•	HARNESS END CONNECTOR
○	HARNESS CONNECTION
#	TERMINAL LABEL

<p>Alfred SUPERIOR EQUIPMENT SOLUTIONS 1085 BIXBY DRIVE CITY OF INDUSTRY, CA. 91745</p>	<p>THE INFORMATION CONTAINED IN THIS DRAWING IS THE SOLE PROPERTY OF SUPERIOR EQUIPMENT SOLUTIONS, INC. ANY REPRODUCTION OR TRANSMISSION OF THIS DRAWING WITHOUT PERMISSION FROM SUPERIOR EQUIPMENT SOLUTIONS, INC. IS PROHIBITED.</p> <p>CUSTOMER: SES C:\SES_PDM\WIRING DIAGRAMS\</p>	<p>DRAWN BY: ADRIAN CRISCI</p>	<p>LAST SAVED: 5/9/2025 7:12:43 AM</p>	<p>DRAWING NO.: W900-0157</p>
		<p>MATERIAL: N/A</p>	<p>PROJECT TITLE: AR-24 / 24D / AR-28 / 28D</p>	<p>PAGE SIZE:</p>
		<p>FINISH: N/A</p>	<p>DRAWING TITLE:</p>	<p>LETTER</p>
		<p>WEIGHT: N/A Lbs.</p>	<p>AR-24 / 24D AND AR-28 / 28D WIRING SCHEMATIC</p>	<p>SHEET 1 OF 1</p>

WIRING SCHEMATIC DIAGRAM AND COMPONENT PART NUMBERS



GOURMET LIMITED WARRANTY

This warranty covers the following: **ALFRESCO GOURMET REFRIGERATORS** (All Models)

DURATION OF WARRANTY

Two Year Limited Warranty:

Alfresco Gourmet Grills (a division of SES, Inc) warrants all refrigerator components to the original purchaser to be free from factory defects in material and workmanship for a period of (2) two years. This warranty covers all parts and labor to repair or replace any part of the product that proves to be defective in materials or workmanship. All service under the above warranty must be performed by an Alfresco factory authorized servicer, unless otherwise specified by Alfresco. Should product deterioration occur to the degree of non-performance a replacement will be furnished FOB City of Industry, CA. Service must be provided during normal business hours. This warranty does not apply if the unit was subject to other than normal household use.

Five Year Sealed System Limited Warranty:

Alfresco Gourmet Grills (a division of SES, Inc) warrants the sealed system for five years from the date of original purchase. This warranty covers all parts and labor to repair or replace the following sealed system parts, that prove to be defective in materials or workmanship: compressor, condenser, evaporator, drier, and all connecting tubing. All service under the sealed system warranty must be performed by an Alfresco factory authorized servicer, unless otherwise specified by Alfresco. Should product deterioration occur to the degree of non-performance a replacement will be furnished FOB City of Industry, CA. Service must be provided during normal business hours. This warranty does not apply if the unit was subject to other than normal household use.

Alfresco Grills WILL cover:

All parts and labor for either the initial two-year limited warranty or total 5 year limited sealed system warranty, for parts found to be defective due to material or workmanship. Authorized Factory Agent must provide service during normal business hours.

Alfresco Grills WILL NOT cover:

- Installation or start-up
- Normal adjustment to temperature
- Damage resulting from accident, alteration, misuse, abuse, hostile environments, improper installation or installation not in accordance with local codes.
- Cleaning and/or general maintenance.
- Shipping damage
- Service by an unauthorized agency.
- Damage or repairs due to service by an unauthorized agency.
- The use of unauthorized parts.
- Overtime, weekends, holidays
- Improper installation, such as: improper hook-up, inadequate ventilation, etc
- Service visits to:
 - Correct the installation. (You are responsible for providing electrical wiring, and other connecting facilities.)
 - Repairs due to other than normal use.
 - Supply the user with operational assistance on site.

Replacement will be FOB Alfresco, City of Industry, California, and Alfresco will not be liable for any transportation costs, labor costs, or export duties. This warranty shall not apply, nor can we assume

responsibility for damage that might result from failure to follow manufacturers instructions or local codes, where the appliance has been tampered with or altered in any way or which, to our judgment, has been subjected to misuse, negligence, or accident. Implied warranty shall not extend beyond the duration of this written warranty. This warranty is in lieu of all other warranties expressed or implied and all other obligations or liability, in connection with the sale of this appliance.

HOW TO OBTAIN SERVICE

WARRANTY SERVICE ONLY !

VISIT US ON THE WEB AT: www.alfrescogrills.com

FOR SERVICE PLEASE CALL: 1 866 203 5607

Please provide:

- Model Number, Serial Number and Date of installation.
 - Located on the serial plate near the top of the inside left wall of the unit.
- A brief description of the problem.

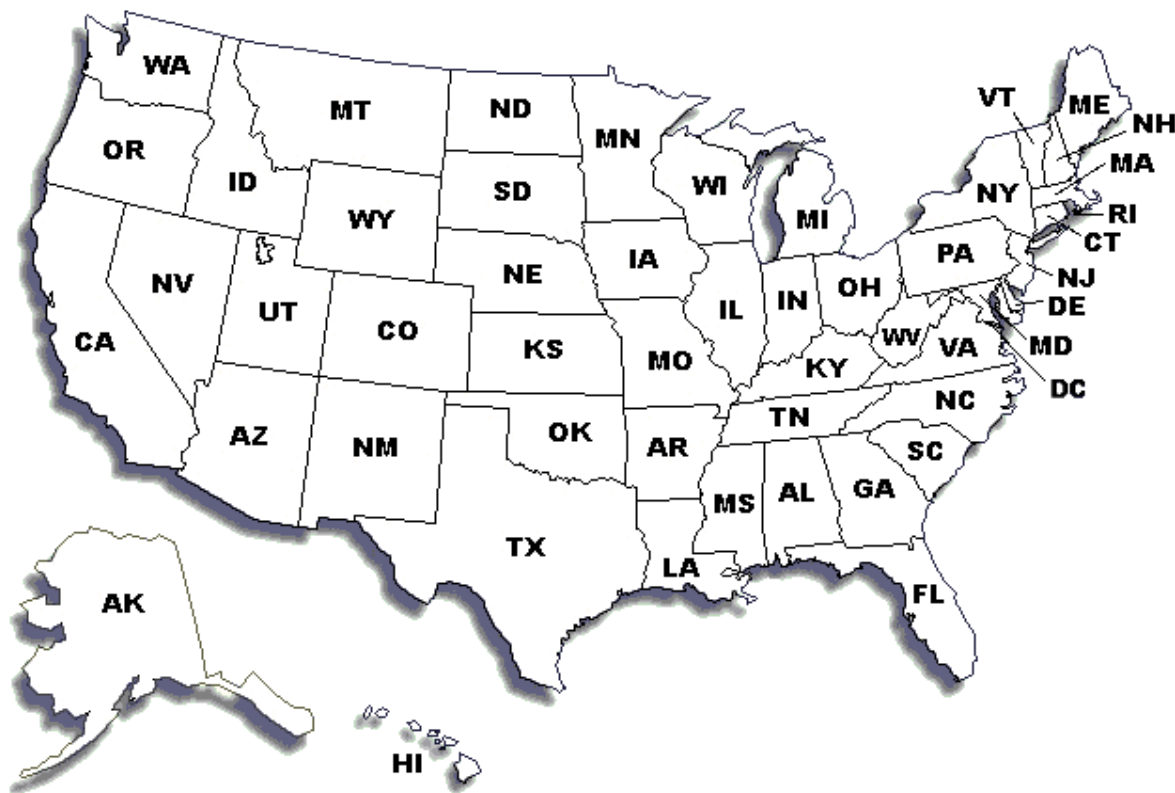

INQUIRIES AND INFORMATION:

For all other Alfresco™ Gourmet Grill information such as power, installation, cut-out requirements, or any other product inquiries, please contact:

Alfresco Gourmet Grills.
Customer Service Department.
1085 Bixby Drive
City of Industry, CA. 91745

(888) 383-8800 or (323) 722-7900
(323) 726-4700. (fax)

CUSTOMER NOTES:

CUSTOMER NOTES:



*Alfresco*TM

Open Air Culinary Systems